

Emmen, Umgestaltung Knoten Gersagplatz

Gemeinde Emmen

Abschnitt Knoten Gersag

Objekt Knoten Gersagplatz

Koordinaten 2°66'3"680 / 1°21'4"230 bis 2°66'3"880 / 1°21'4"640

Querprofil 1:100, Achse A01 - Rüeggisingerstrasse Nord

Bauprojekt Vernehmlassung

Verfasser Emch+Berger WSB AG	Dokument-Nr. 423102 - 220	Reg.-Nr. (Sundbauten) 423102 - 220
Dokument-Nr. Projektverfasser 423102 - 220	Reg.-Nr. (Wasserbau)	
Datensatzname	Kornat 60 / 147	Maassstab 1:100
Status	Datum / erstellt 31.10.2024 / PA	Datum / geprüft
Bauprojekt	Version / Änderungsdatum	Datum / geprüft
Projektstellung	eingegangen	geprüft
	Freigabe	



Emch+Berger WSB AG  
Emmenriederstrasse 10, Emmen, Schweiz  
emch@emchberger.ch | www.emchberger.ch  
Gesamtlösungen sind unser Plus.

QP M 0.00

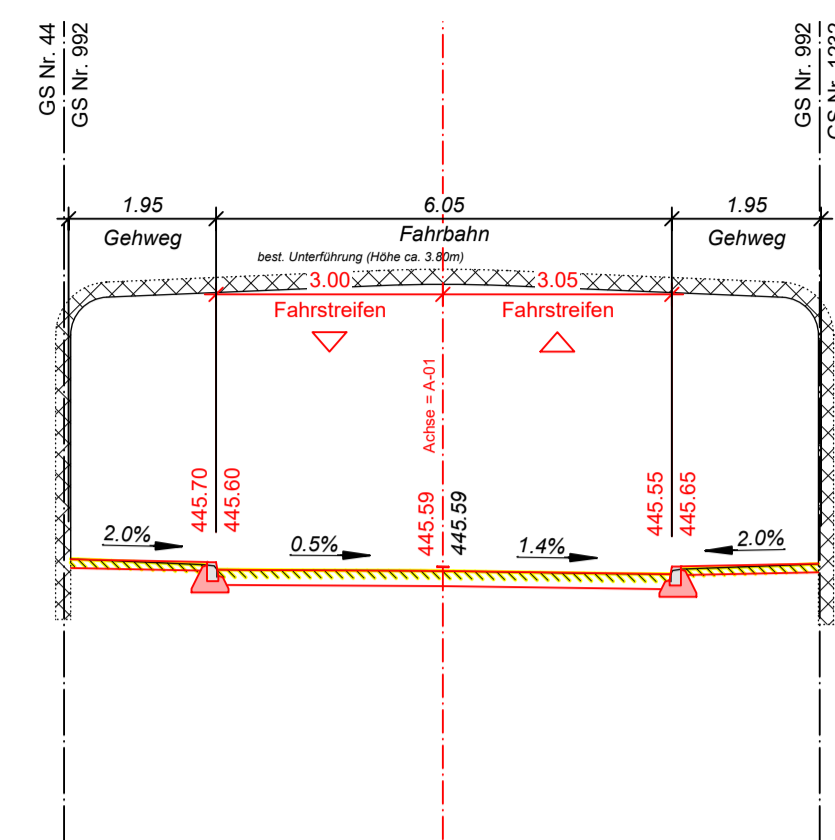

Horizont 442.00m ü.M.

QP M 78.80

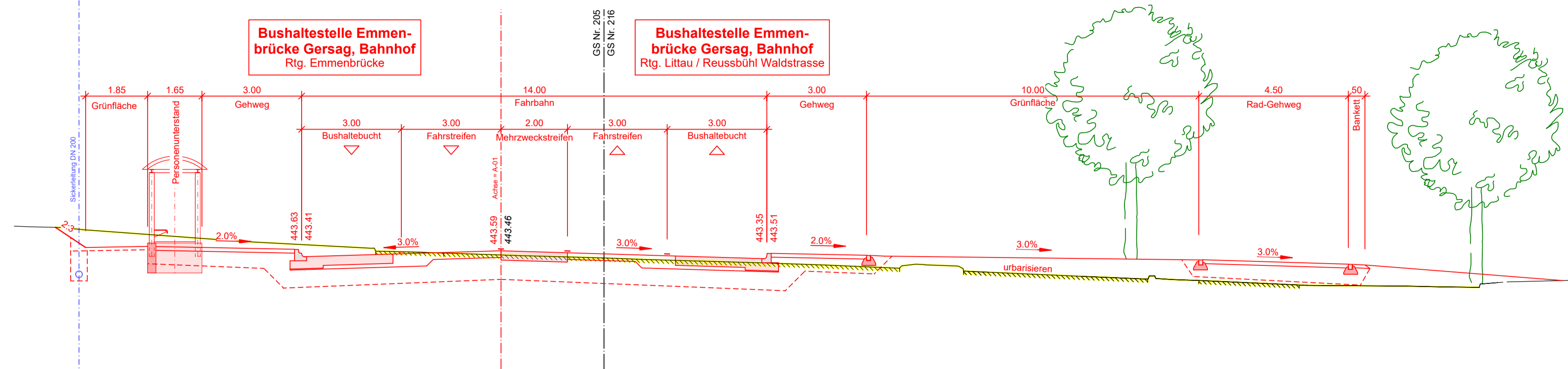

Horizont 440.00m ü.M.

QP M 142.80

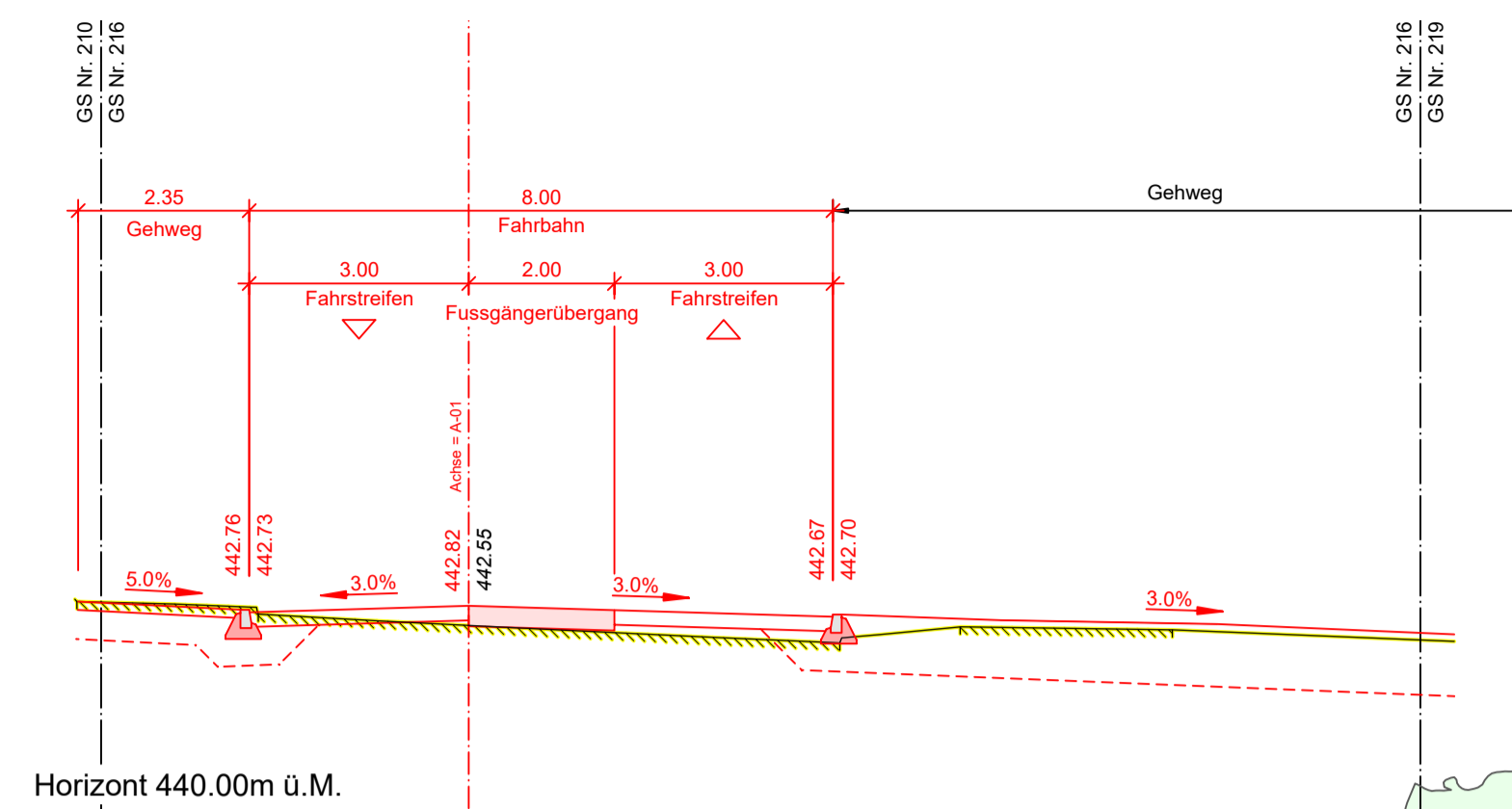

Horizont 440.00m ü.M.

QP M 12.20

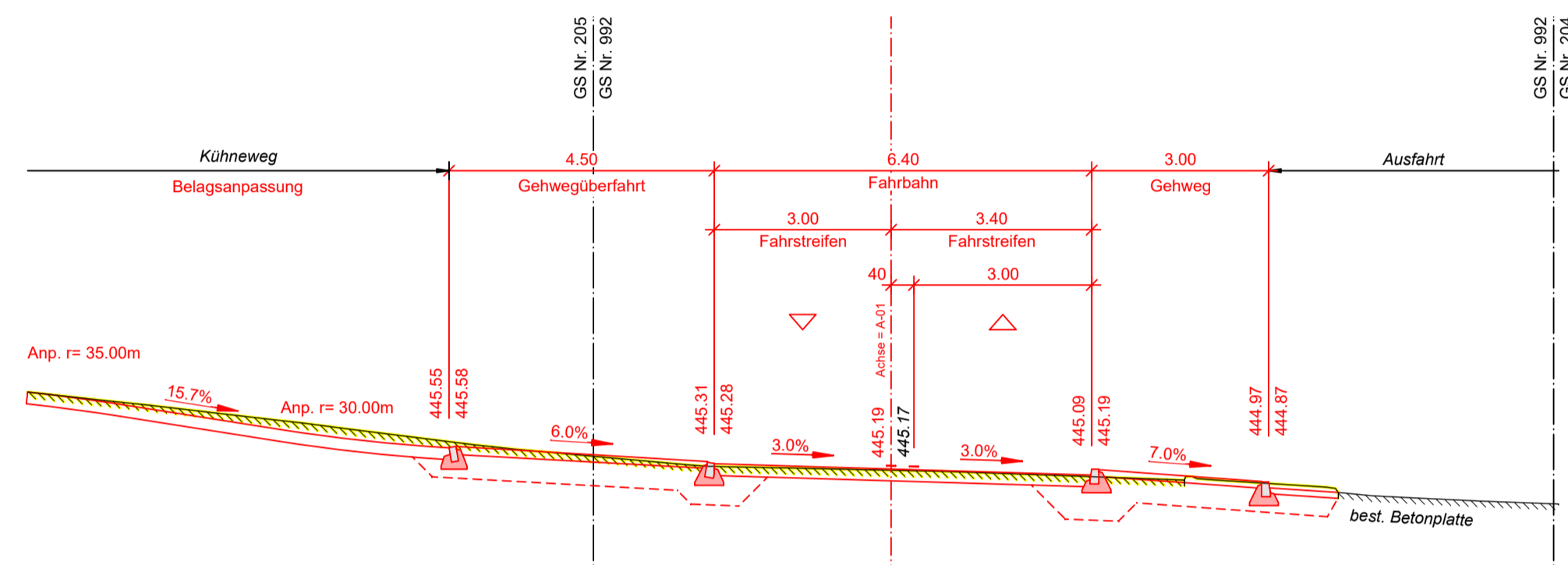

Horizont 442.00m ü.M.

QP M 95.00

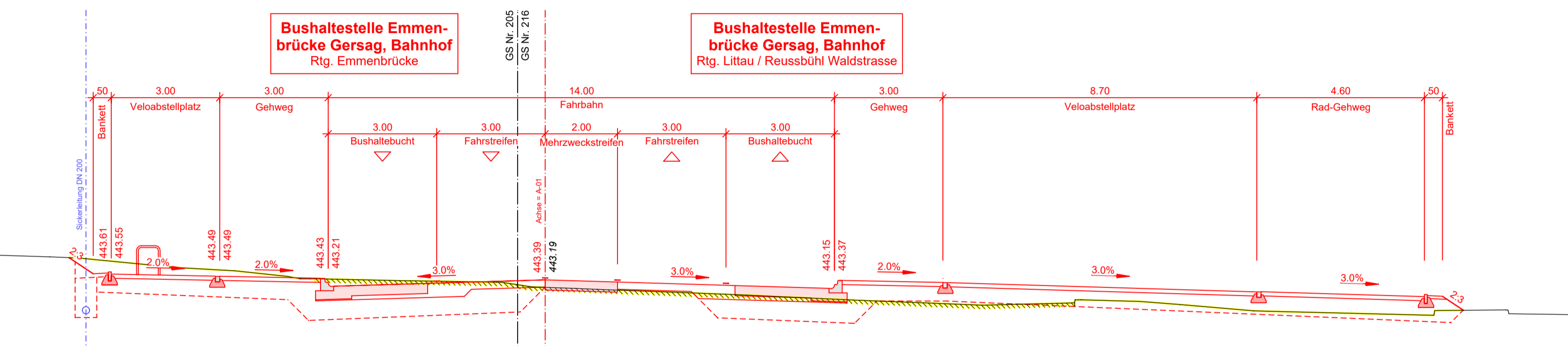

Horizont 440.00m ü.M.

QP M 181.80

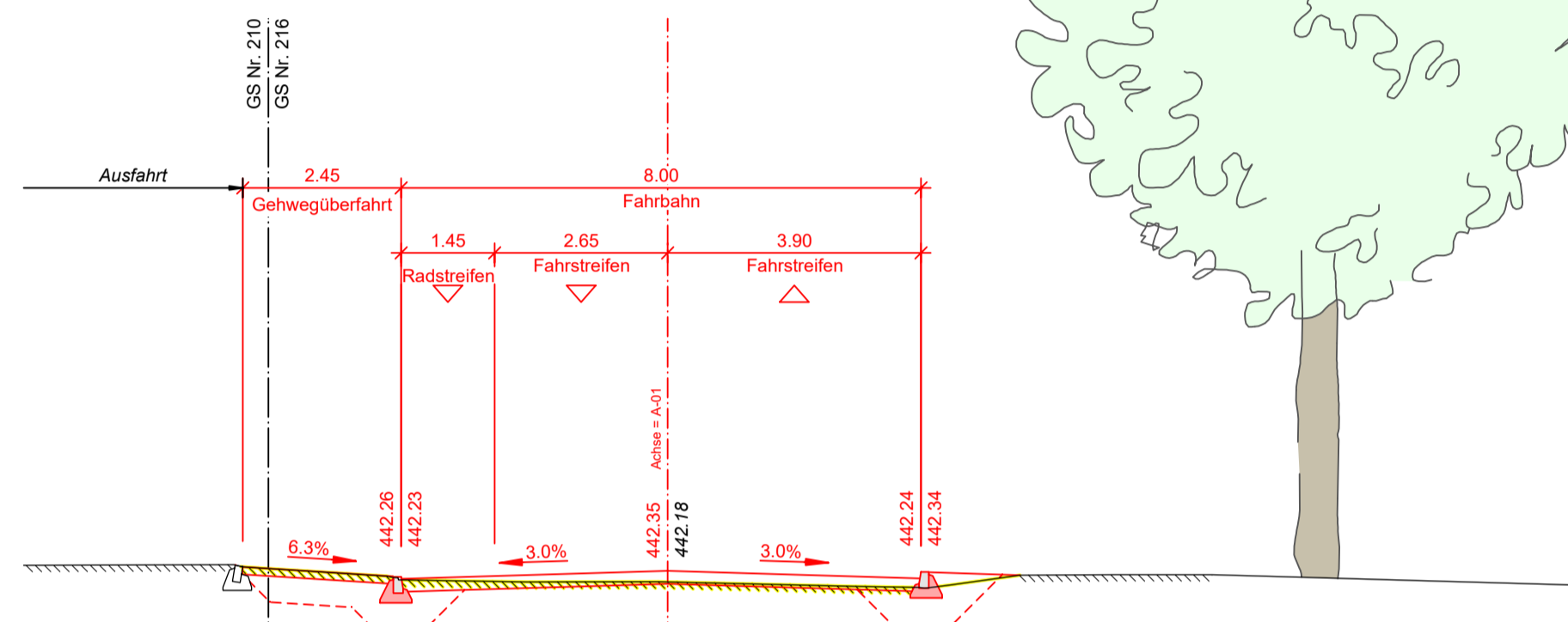

Horizont 440.00m ü.M.

QP M 16.10

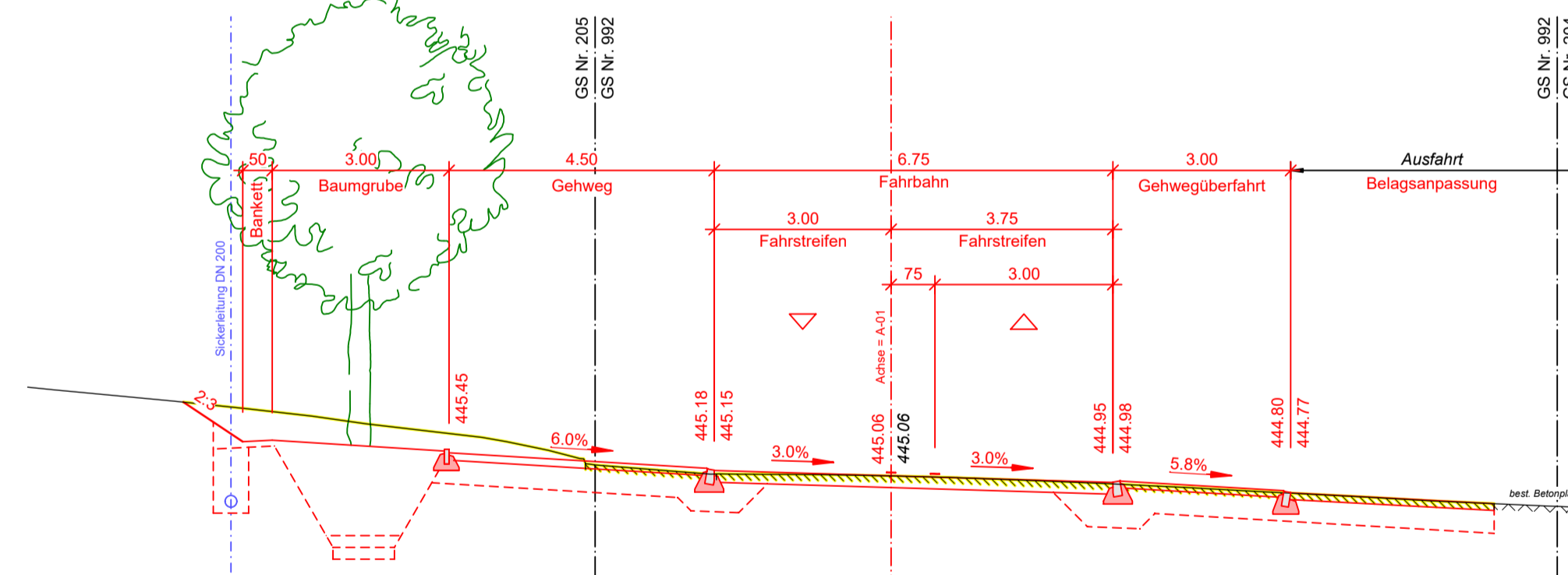

Horizont 442.00m ü.M.

QP M 110.80

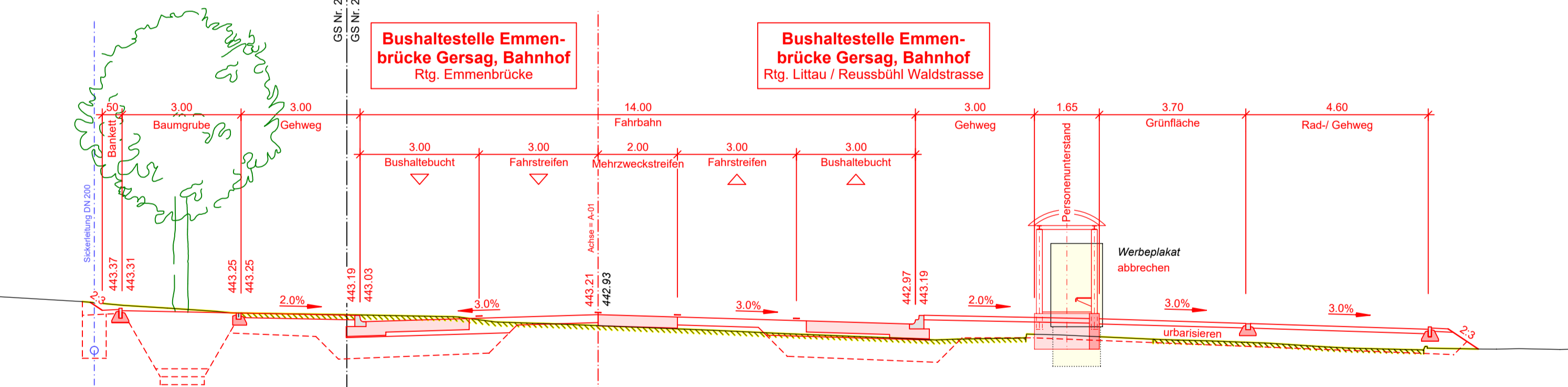

Horizont 440.00m ü.M.

QP M 49.67

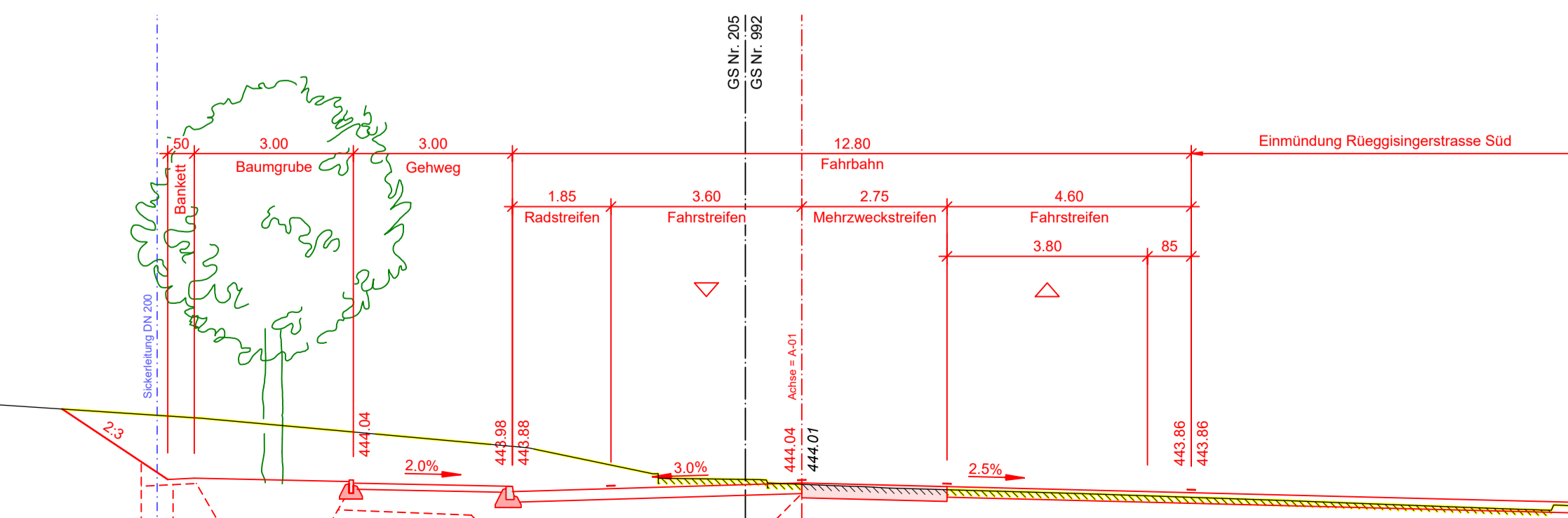

Horizont 442.00m ü.M.

QP M 128.00

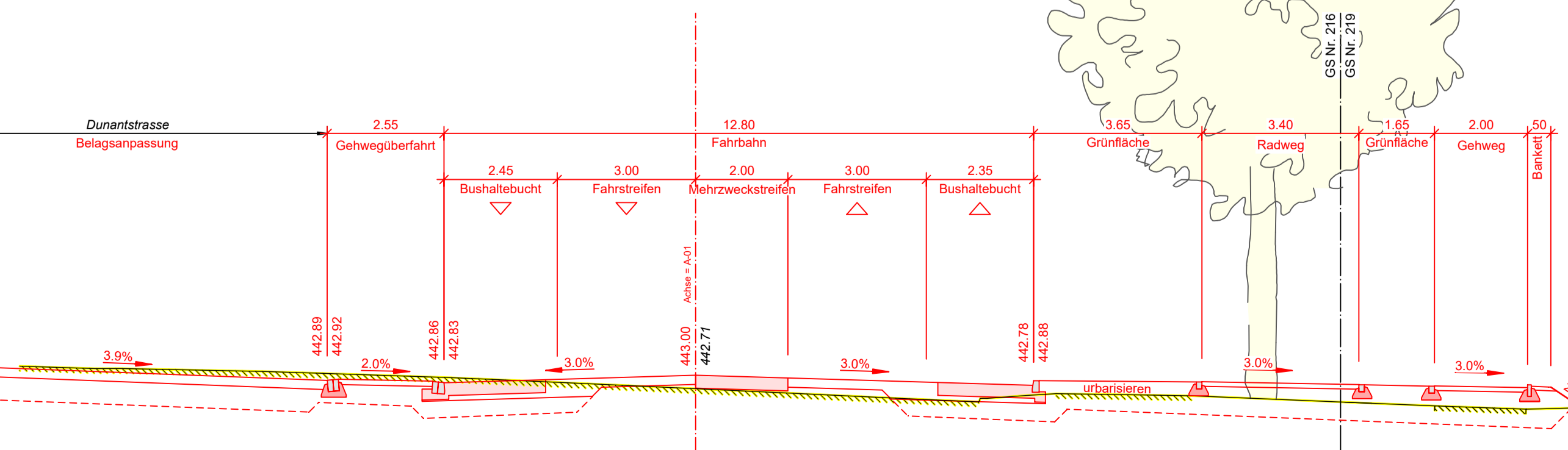

Horizont 440.00m ü.M.